



Self-Serve Terminal

Terminal Update – Coming Soon

The following updates will be available on the Self-Serve Terminal. Review this Information Sheet for more details on each update

- Winning Tickets with Draws Remaining can be Validated
- Winning Tickets with a Free Play Prize, Players can now add an Extra
- Keno Pattern Play Ticket purchase process is easier
- Players can now Clear their Cart with one button

Winning Tickets with Draws Remaining

A Player is **NOW** able to validate a Winning Ticket with Draws Remaining

1. Ticket is placed in the Ticket Scanner
2. A pop-up will give the Player the option to **validate** by selecting **EXCHANGE**
3. Winnings will be added to Player's **Wallet** and an Exchange Ticket will print from the SST

Ticket checker

You have a winning ticket

Your ticket 100016260949 has draws remaining

\$10.00

Your Selections

Keno

1

7

13

38

49

45

58

Winning Numbers

Thu 05/15/2025

2

9

11

13

14

15

17

21

38

49

51

52

53

58

60

73

75

78

79

81

CLOSE

REPLAY

EXCHANGE



Text or Call **Lottery Retail Support:**
1-800-667-1649





Self-Serve Terminal

Terminal Update – Coming Soon

Free Play Winning Tickets

A Player is **NOW** able to add an Extra to their Free Play Ticket on the SST

1. Ticket is placed in the Ticket Scanner
2. A pop-up will give the Player the option to add Extras to their Free Play Ticket
3. Player selects the amount of Extras they want and tap **Add to Cart**

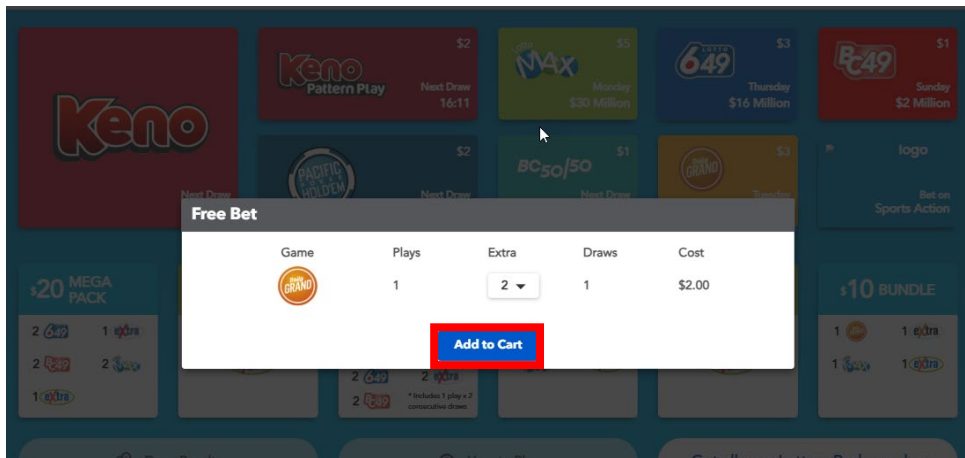

4. If there are sufficient funds in the Player's Wallet, the Ticket will be added to Player's Cart and **automatically print**.

OR

If there are insufficient funds in the Player's Wallet, the Ticket will be added to the Player's Cart. Player taps:

- **Return To Cart → Checkout → Play Selections**

Additional Payment pop-up appears, prompting the Player to **insert Cash** or **Pay with Card**. Once completed, **Ticket will print**

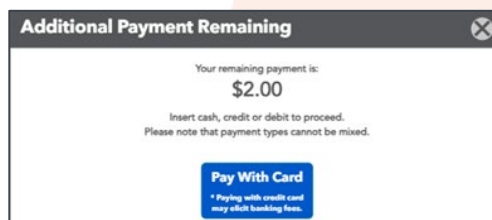

Text or Call **Lottery Retail Support:**
1-800-667-1649





Self-Serve Terminal

Terminal Update – Coming Soon

Clear Cart Function

Previously, Players would have to delete line items one at a time. There is now a **Clear Cart Function**.

1. Player navigates to **My Cart**
2. To delete all line items, the Player taps **Clear Cart**
3. A pop-up will give the Player the option to clear the cart, they can either choose **Cancel** or **Clear**

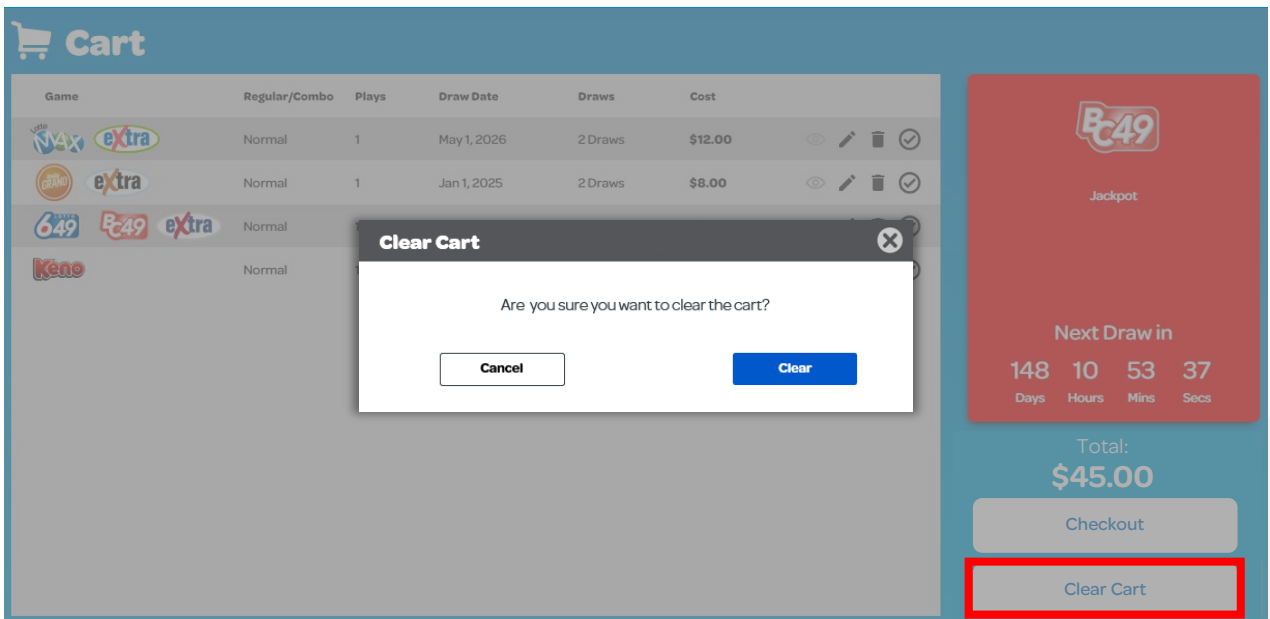

Keno Pattern Play purchase simplified

Players will have an easier purchase journey of Keno Pattern Play Tickets. With the update, a redundant step has been eliminated.

- Please note that Rows & Columns will not reflect this change



Text or Call **Lottery Retail Support:**
1-800-667-1649

